NEWS RELEASE

DATE: May 14, 2021

Erickson Playfield Temporary Closure in Preparation for Generation II Dream Playground

Erickson Playfield will be closed on Monday, May 17, through Tuesday, May 18, 2021, to prepare for construction work on the Generation II Dream Playground. The park is expected to reopen on Wednesday, May 19, 2021.

The new playground will be installed during the month of June 2021 as part of a community build project. Playground improvements include educational and inclusive play elements, improved lines of sight, and a safer, longer-lasting ground cover.

The Parks & Recreation Department has prepared a tree mitigation replacement plan for Erickson Playfield that will remove and replace trees at a ratio of 2:1. Tree planting will occur in October 2021, after the completion of the Generation II Dream Playground and the Erickson Playfield Pump Track project.

For more information on the Generation II Dream Playground, including the new playground design, volunteer and sponsorship opportunities, please visit the Dream Playground Foundation website: www.padreamplayground.org. You can also find information on the Parks & Recreation website: www.cityofpa.us/161/Parks-Recreation.

Provided by:

Corey Delikat
Parks & Recreation Director
Phone: 360-417-4551
Email: cdelikat@cityofpa.us
Website: www.cityofpa.us





Figure 1: Port Angeles Dream Playground Design



Figure 2: Foreverlawn Playground Grass. (n.d.). Playground Grass. <https://www.playgroundgrass.com/play-stories/photo-gallery/>.



Figure 3: 4-person See-Saw allows multiple children to play at once. This element stimulates the vestibular system, which is important for development.



Figure 4: Inclusive Orbit (Merry-Go-Round) has a revolving deck which is flush with the surrounding surface, enabling wheelchair users direct access to the equipment.



Figure 5: Spinners provide an opportunity to stimulate the vestibular system - important for development.



Figure 6: Inclusive swing seat can be used by children of all abilities.



Figure 7: High/Low (ADA) Monkey Bars allow children of differing abilities to play side by side.

Notes:
 All traces shown are existing to remain.
 Appropriate locations. Please provide
 architectural survey.

Stack/	N
NA Scale	
Revised:	
11.13.19	
12.14.19	
2.11.20	
04.1.20	
11.12.20	
12.1.20	
2.4.21	

Eighth Scale
 Playground Plan Drawing

Project Name:
 Fort Angeles Dream Playground
 Fort Angeles, WA

play
 design
 119 West Buffalo Street
 THICK, NY 14850
 807-351-5140
 PBDplaygrounds.com

Drawing No:
 2

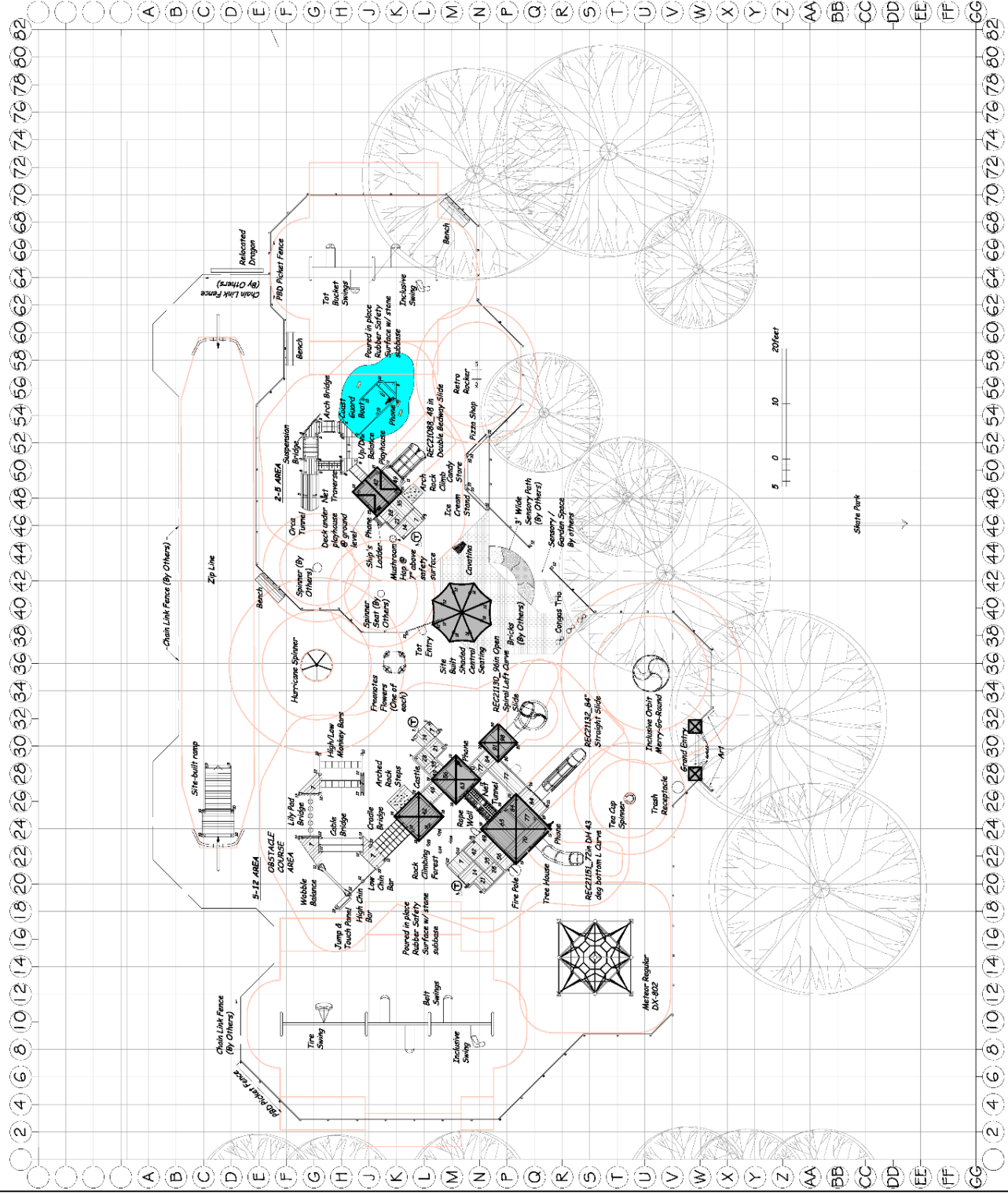



2021 Tree Mitigation Plan for Erickson Playground

- 10 Dogwood Trees (Pump Track Area)- 5 Pagoda & 5 Cherokee Chief (20'H/20'SP)
- 3 Chancellor Lindens (Francis & 4th Lawn Area) (35'H/20'SP)
- 5 Athena Elm (Francis & 4th Lawn Area) (30H'/35'SP)
- 3 Apollo Maples (Francis & 2nd/3rd)- (25H'/10'SP)
- 3 Norway Maples (Francis & 2nd/3rd)- (35H'/15'SP)
- 3 Yellow Witch Hazel (Outside Area of Gen II Playground)- (10H'/10'SP)
- 3 Diane Witch Hazel (Outside Area of Gen II Playground)- (10H'/10'SP)

*The Current Canopy of the 15 Trees Being Removed= 300' (AVG 231' Min/385' Max)
 *8 Firs- 12'Min/20'Max @ Maturity
 *7 Cedars- 15'Min/25'Max @ Maturity

*Proposed Mitigation Approx. Canopy of 30 Trees= 575' Max

**The precise location of the 10 trees next to the Pump Track & Gen II Playground may change slightly once the after the installation of two projects

